

cemintel™

fibre cement systems

WET AREA INSTALLATION

CHECKLIST AND HANDY HINTS

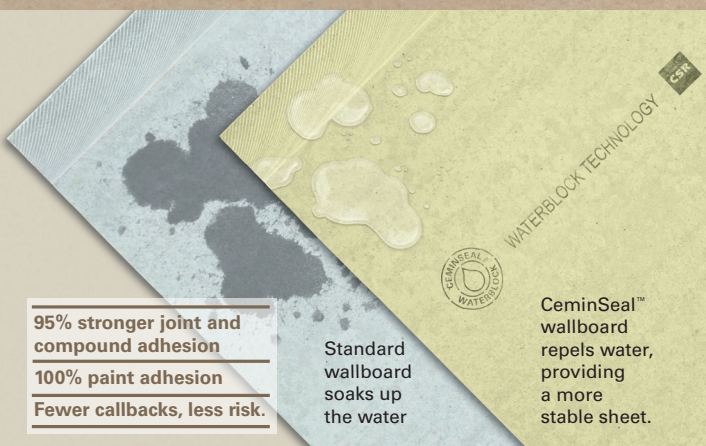

- 95% stronger joint and compound adhesion
- 100% paint adhesion
- Fewer callbacks, less risk.

Standard wallboard soaks up the water

CeminSeal™ wallboard repels water, providing a more stable sheet.

SHOPPING LIST

- ✓ CeminSeal™ Wallboard
- ✓ Wallboard nails or screws
- ✓ Flexible sealout SikaPro FC
- ✓ PVC Vertical Corner Angle
- ✓ PVC Perimeter Angle Flashing
- ✓ Gyprock™ Wet Area Base Coat
- ✓ Gyprock™ Paper Tape 75m
- ✓ Membrane

CeminSeal™ Wallboard Installation

It is recommended that all CeminSeal™ Wallboard Sheets be applied horizontally. This is to reduce the extent of joint visibility in glaring light conditions. Sheets can be fixed vertically in tiled areas.

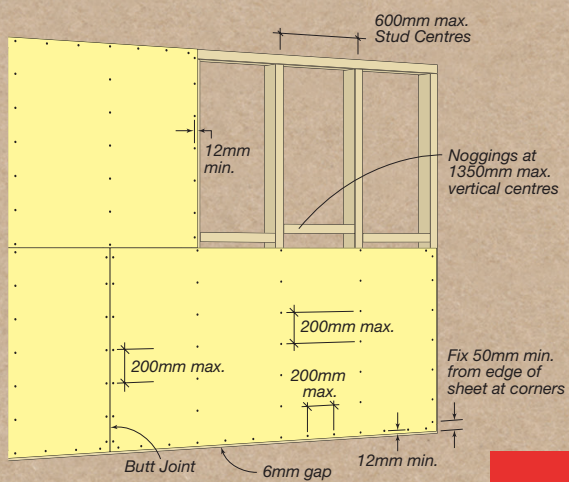

For more information ask instore or refer to www.cemintel.com.au

A full Wet Area installation Technical Manual is also available

cemintel™

fibre cement systems

Insitu-Formed Internal Shower Tray

Only insitu membrane materials appraised by recognised authorities are to be used. For example ABA Superflex I.

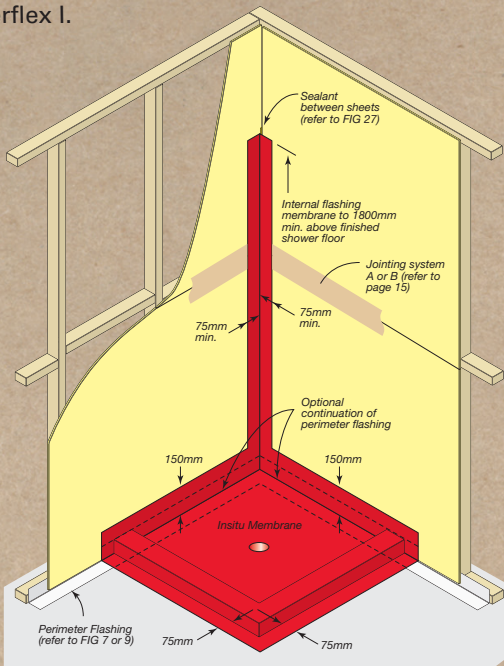

TILED AREAS - Jointing Of Recessed Joints (Butt Joints Similar)

TAPE COAT.

1. Fill recess evenly and fully with Wet Area Base Coat.
2. Bed in the tape centrally over the joint, and cover lightly with Wet Area Base Coat.
3. Cover all fastener heads with Wet Area Base Coat.
4. Allow tape coat to completely dry before proceeding.

SECOND COAT.

1. Apply a second coat, about 180mm width, with enough compound to cover the tape. Feather edges.
2. Cover fastener heads with a second coat, extending beyond the first coat by about 25mm.
3. Allow the second coat to dry completely before proceeding.

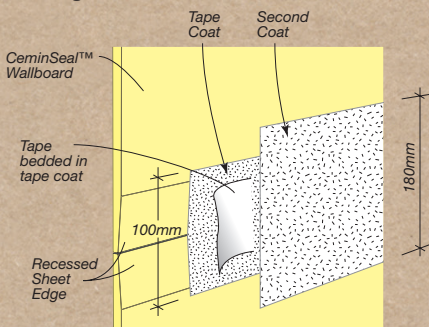

CSR

For more information ask instore or refer to www.cemintel.com.au

A full Wet Area installation Technical Manual is also available